

To ensure loading and movement on tracheostomy tube is kept to a minimum, make sure the lanyard is secured properly.

Lanyard position as shown in **1a** is not suitable for patients with damaged skin.

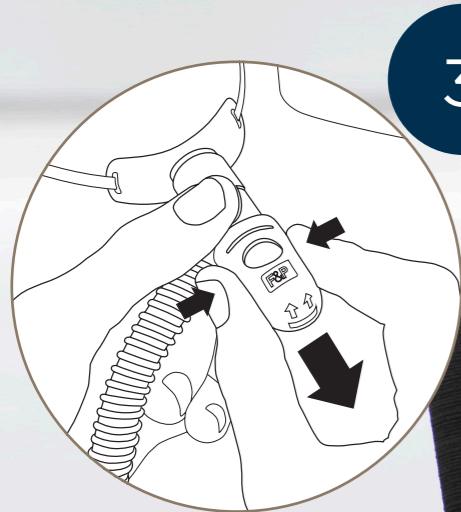

Orientate the sputum guard so that sputum drains downwards. The sputum guard can be removed if required.

i IMPORTANT: Always refer to the user instructions supplied with the product for full set up instructions, warnings, cautions and contraindications.

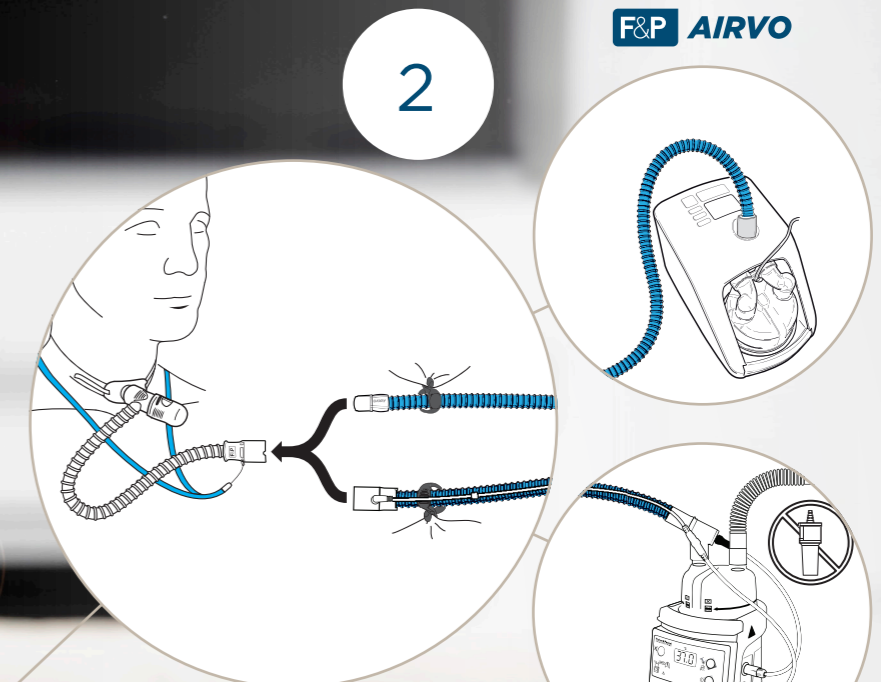

Connect to the humidification system. Make sure all connections are secure.

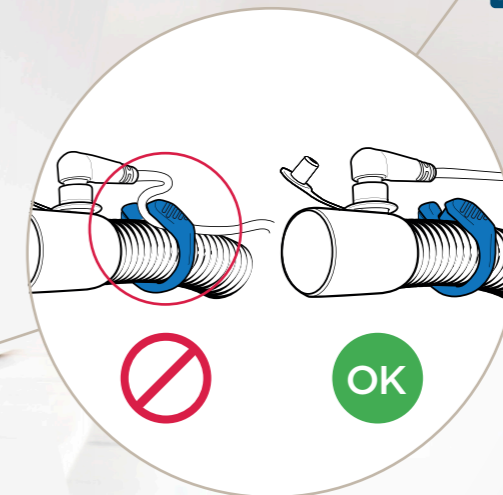

If using an MR850, attach the tubing clip to the breathing circuit but ensure probe cable is not crushed by tubing clip.